

# 10 [ curva piana 45° | 45° horizontal bend ]

PFL

[ curva piana 45° | 45° horizontal bend ]

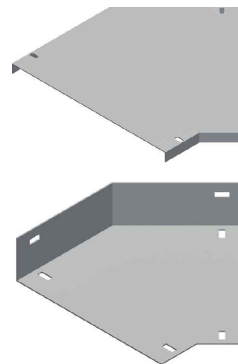
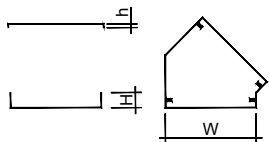

### ELEMENTO | ELEMENT

Descr.	H	W	R	Th
PFL25-C45-1-50	25	50	150	1
PFL25-C45-1-100	25	100	150	1
PFL25-C45-1-50	25	50	150	1,2
PFL25-C45-1-100	25	100	150	1,2
PFL50-C45-1-50	50	50	150	1,2
PFL50-C45-1-100	50	100	150	1,2
PFL50-C45-1-200	50	200	150	1,2
PFL50-C45-1-300	50	300	150	1,2
PFL50-C45-1-50	50	50	150	1,5
PFL50-C45-1-100	50	100	150	1,5
PFL50-C45-1-200	50	200	150	1,5
PFL50-C45-1-300	50	300	150	1,5
PFL75-C45-1-100	75	100	150	1,2
PFL75-C45-1-200	75	200	150	1,2
PFL75-C45-1-300	75	300	150	1,2
PFL75-C45-1-400	75	400	150	1,2
PFL75-C45-1-500	75	500	150	1,2
PFL75-C45-1-100	75	100	150	1,5
PFL75-C45-1-200	75	200	150	1,5
PFL75-C45-1-300	75	300	150	1,5
PFL75-C45-1-400	75	400	150	1,5
PFL75-C45-1-500	75	500	150	1,5

### CODICE | CODE

HDG	AISI 304	AISI 316
PZC41001BCS	PIC41001BCS	PYC41001BCS
PZC41002BCS	PIC41002BCS	PYC41002BCS
PZC41001AXQ	PIC41001AXQ	PYC41001AXQ
PZC41002AXQ	PIC41002AXQ	PYC41002AXQ
PZC41001AKA	PIC41001AKA	PYC41001AKA
PZC41002AKA	PIC41002AKA	PYC41002AKA
PZC41004AKA	PIC41004AKA	PYC41004AKA
PZC41006AKA	PIC41006AKA	PYC41006AKA
E0C41201	PIC41001AGD	PYC41001AGD
E0C41202	PIC41002AGD	PYC41002AGD
E0C41204	PIC41004AGD	PYC41004AGD
E0C41206	PIC41006AGD	PYC41006AGD
PZC41002ASO	PIC41002ASO	PYC41002ASO
PZC41004ASO	PIC41004ASO	PYC41004ASO
PZC41006ASO	PIC41006ASO	PYC41006ASO
PZC41008ASO	PIC41008ASO	PYC41008ASO
PZC41010ASO	PIC41010ASO	PYC41010ASO
E0C41302	PIC41002AGC	PYC41002AGC
E0C41304	PIC41004AGC	PYC41004AGC
E0C41306	PIC41006AGC	PYC41006AGC
E0C41308	PIC41008AGC	PYC41008AGC
E0C41310	PIC41010AGC	PYC41010AGC

### COPERCHIO | COVER

Descr.	h	W	R	Th
PFL-CC45-1-50	12	50	150	1
PFL-CC45-1-100	12	100	150	1
PFL-CC45-1-200	12	200	150	1
PFL-CC45-1-300	12	300	150	1
PFL-CC45-1-400	12	400	150	1
PFL-CC45-1-500	12	500	150	1

### CODICE | CODE

HDG	AISI 304	AISI 316
L0C41001	CIC41001AFT	CYC41001AFT
L0C41002	CIC41002AFT	CYC41002AFT
L0C41004	CIC41004AFT	CYC41004AFT
L0C41006	CIC41006AFT	CYC41006AFT
L0C41008	CIC41008AFT	CYC41008AFT
L0C41010	CIC41010AFT	CYC41010AFT

**A Richiesta.** Materiale: Alluminio - Finitura: Verniciatura - Altezza (H): 50+100 mm - Raggio (R): 100+300 mm - Spessore (Th): 1,0 - 1,2 - 1,5 - 2 mm.  
**On request.** Material: Aluminium - Finish: Paint job - Height (H): 50+100 mm - Radius (R): 100+300 mm - Thickness (Th): 1,0 - 1,2 - 1,5 - 2 mm.