

# 16 [ derivazione T | tee ]

PFLR

[ derivazione T | tee ]

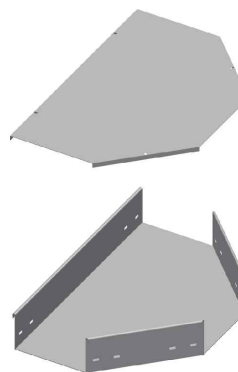
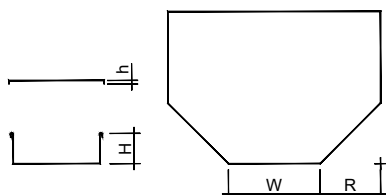

### ELEMENTO | ELEMENT

Descr.	H	W	R	Th
PFLR60-T-2-100	60	100	200	1,2
PFLR60-T-2-200	60	200	200	1,2
PFLR60-T-2-300	60	300	200	1,2
PFLR60-T-2-400	60	400	200	1,2
PFLR60-T-2-500	60	500	200	1,2
PFLR60-T-2-600	60	600	200	1,2
PFLR60-T-2-100	60	100	200	1,5
PFLR60-T-2-200	60	200	200	1,5
PFLR60-T-2-300	60	300	200	1,5
PFLR60-T-2-400	60	400	200	1,5
PFLR60-T-2-500	60	500	200	1,5
PFLR60-T-2-600	60	600	200	1,5
PFLR100-T-2-100	100	100	200	1,5
PFLR100-T-2-200	100	200	200	1,5
PFLR100-T-2-300	100	300	200	1,5
PFLR100-T-2-400	100	400	200	1,5
PFLR100-T-2-500	100	500	200	1,5
PFLR100-T-2-600	100	600	200	1,5
PFLR100-T-2-100	100	100	200	2
PFLR100-T-2-200	100	200	200	2
PFLR100-T-2-300	100	300	200	2
PFLR100-T-2-400	100	400	200	2
PFLR100-T-2-500	100	500	200	2
PFLR100-T-2-600	100	600	200	2

### CODICE | CODE

HDG	AISI 304	AISI 316
PZT02002AJX	PIT02002AJX	PYT02002AJX
PZT02004AJX	PIT02004AJX	PYT02004AJX
PZT02006AJX	PIT02006AJX	PYT02006AJX
PZT02008AJX	PIT02008AJX	PYT02008AJX
PZT02010AJX	PIT02010AJX	PYT02010AJX
PZT02012AJX	PIT02012AJX	PYT02012AJX
Ⓜ BOT02002	PIT02002AEU	PYT02002AEU
Ⓜ BOT02004	PIT02004AEU	PYT02004AEU
Ⓜ BOT02006	PIT02006AEU	PYT02006AEU
Ⓜ BOT02008	PIT02008AEU	PYT02008AEU
Ⓜ BOT02010	PIT02010AEU	PYT02010AEU
Ⓜ BOT02012	PIT02012AEU	PYT02012AEU
Ⓜ COT02002	PIT02002AEQ	PYT02002AEQ
Ⓜ COT02004	PIT02004AEQ	PYT02004AEQ
Ⓜ COT02006	PIT02006AEQ	PYT02006AEQ
Ⓜ COT02008	PIT02008AEQ	PYT02008AEQ
Ⓜ COT02010	PIT02010AEQ	PYT02010AEQ
Ⓜ COT02012	PIT02012AEQ	PYT02012AEQ
PZT02002AQQ	PIT02002AQQ	PYT02002AQQ
PZT02004AQQ	PIT02004AQQ	PYT02004AQQ
PZT02006AQQ	PIT02006AQQ	PYT02006AQQ
PZT02008AQQ	PIT02008AQQ	PYT02008AQQ
PZT02010AQQ	PIT02010AQQ	PYT02010AQQ
PZT02012AQQ	PIT02012AQQ	PYT02012AQQ

### COPERCHIO | COVER

Descr.	h	W	R	Th
PFLR-CT-2-100	12	100	200	1
PFLR-CT-2-200	12	200	200	1
PFLR-CT-2-300	12	300	200	1
PFLR-CT-2-400	12	400	200	1
PFLR-CT-2-500	12	500	200	1
PFLR-CT-2-600	12	600	200	1

### CODICE | CODE

HDG	AISI 304	AISI 316
HOT02002	CIT02002ACT	CYT02002ACT
HOT02004	CIT02004ACT	CYT02004ACT
HOT02006	CIT02006ACT	CYT02006ACT
HOT02008	CIT02008ACT	CYT02008ACT
HOT02010	CIT02010ACT	CYT02010ACT
HOT02012	CIT02012ACT	CYT02012ACT

**A Richiesta.** Materiale: Alluminio - Finitura: Verniciatura - Altezza (H): 50+150 mm - Raggio (R): 300+1000 mm - Spessore (Th): 1,0 - 1,2 - 1,5 - 2 mm.  
**On request.** Material: Aluminium - Finish: Paint job - Height (H): 50+150 mm - Radius (R): 300+1000 mm - Thickness (Th): 1,0 - 1,2 - 1,5 - 2 mm.