

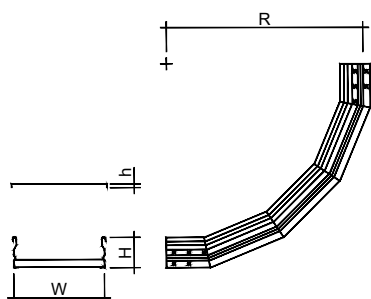

[curva salita 90° | 90° internal vertical bend]



ELEMENTO | ELEMENT

Descr.	H	W	R	Th
PTR100-CS90-6-100	100	100	600	1,2
PTR100-CS90-6-200	100	200	600	1,2
PTR100-CS90-6-300	100	300	600	1,2
PTR100-CS90-6-400	100	400	600	1,2
PTR100-CS90-6-500	100	500	600	1,2
PTR100-CS90-6-600	100	600	600	1,2
PTR100-CS90-6-100	100	100	600	1,5
PTR100-CS90-6-200	100	200	600	1,5
PTR100-CS90-6-300	100	300	600	1,5
PTR100-CS90-6-400	100	400	600	1,5
PTR100-CS90-6-500	100	500	600	1,5
PTR100-CS90-6-600	100	600	600	1,5
PTR150-CS90-6-200	150	200	600	1,5
PTR150-CS90-6-300	150	300	600	1,5
PTR150-CS90-6-400	150	400	600	1,5
PTR150-CS90-6-500	150	500	600	1,5
PTR150-CS90-6-600	150	600	600	1,5
PTR150-CS90-6-800	150	800	600	1,5
PTR150-CS90-6-200	150	200	600	2
PTR150-CS90-6-300	150	300	600	2
PTR150-CS90-6-400	150	400	600	2
PTR150-CS90-6-500	150	500	600	2
PTR150-CS90-6-600	150	600	600	2
PTR150-CS90-6-800	150	800	600	2

CODICE | CODE

HDG	AISI 304	AISI 316
N0S96002	PIS96002APH	PYS96002APH
N0S96004	PIS96004APH	PYS96004APH
N0S96006	PIS96006APH	PYS96006APH
N0S96008	PIS96008APH	PYS96008APH
N0S96010	PIS96010APH	PYS96010APH
N0S96012	PIS96012APH	PYS96012APH
A0S96002	PIS96002ANU	PYS96002ANU
A0S96004	PIS96004ANU	PYS96004ANU
A0S96006	PIS96006ANU	PYS96006ANU
A0S96008	PIS96008ANU	PYS96008ANU
A0S96010	PIS96010ANU	PYS96010ANU
A0S96012	PIS96012ANU	PYS96012ANU
PZS96004AMT	PIS96004AMT	PYS96004AMT
PZS96006AMT	PIS96006AMT	PYS96006AMT
PZS96008AMT	PIS96008AMT	PYS96008AMT
PZS96010AMT	PIS96010AMT	PYS96010AMT
PZS96012AMT	PIS96012AMT	PYS96012AMT
PZS96016AMT	PIS96016AMT	PYS96016AMT
PZS96004ALO	PIS96004ALO	PYS96004ALO
PZS96006ALO	PIS96006ALO	PYS96006ALO
PZS96008ALO	PIS96008ALO	PYS96008ALO
PZS96010ALO	PIS96010ALO	PYS96010ALO
PZS96012ALO	PIS96012ALO	PYS96012ALO
PZS96016ALO	PIS96016ALO	PYS96016ALO

COPERCHIO | COVER

Descr.	h	W	R	Th
PTR100-CCS90-6-100	12	100	600	1
PTR100-CCS90-6-200	12	200	600	1
PTR100-CCS90-6-300	12	300	600	1
PTR100-CCS90-6-400	12	400	600	1
PTR100-CCS90-6-500	12	500	600	1
PTR100-CCS90-6-600	12	600	600	1
PTR150-CCS90-6-200	12	200	600	1
PTR150-CCS90-6-300	12	300	600	1
PTR150-CCS90-6-400	12	400	600	1
PTR150-CCS90-6-500	12	500	600	1
PTR150-CCS90-6-600	12	600	600	1
PTR150-CCS90-6-800	12	800	600	1

CODICE | CODE

HDG	AISI 304	AISI 316
G0S96002	CIS96002AFM	CYS96002AFM
G0S96004	CIS96004AFM	CYS96004AFM
G0S96006	CIS96006AFM	CYS96006AFM
G0S96008	CIS96008AFM	CYS96008AFM
G0S96010	CIS96010AFM	CYS96010AFM
G0S96012	CIS96012AFM	CYS96012AFM
CZS96004AEY	CIS96004AEY	CYS96004AEY
CZS96006AEY	CIS96006AEY	CYS96006AEY
CZS96008AEY	CIS96008AEY	CYS96008AEY
CZS96010AEY	CIS96010AEY	CYS96010AEY
CZS96012AEY	CIS96012AEY	CYS96012AEY
CZS96016AEY	CIS96016AEY	CYS96016AEY

A Richiesta. Materiale: Alluminio - Finitura: Verniciatura - Altezza (H): 125, 185, 200 mm - Raggio (R): 300+1000 mm - Spessore (Th): 1,2 -1,5 - 2 mm - Interasse (i): <300mm.
 On request, Material: Aluminium - Finish: Paint job - Height (H): 125, 185, 200 mm - Radius (R): 300+1000 mm - Thickness (Th): 1,2 - 1,5 - 2 mm - Rungs pitch (i): <300mm.