

[sostegni e fissaggi | supports and fasteners]





[sostegni e fissaggi | supports and fasteners]

3

INDICE	INDEX	
Note tecniche	<i>Technical informations</i>	4-5
Sostegno verticale asolato	<i>Holed vertical support</i>	6
Sostegno verticale semplice	<i>Simple vertical support</i>	7
Sostegno verticale doppio	<i>Double vertical support</i>	8
Sostegno orizzontale	<i>Horizontal support</i>	9-10
Fissaggio sostegno verticale	<i>Vertical support fastener</i>	11-16
Fissaggio a trave	<i>Rack fastening clamp</i>	17
Cavallotto per fissaggio a trave	<i>U bolt for rack fastening clamp</i>	17
Staffa fissaggio tubi per PTR	<i>Pipe fixing brackets for PTR</i>	18
Staffa fissaggio tubi per PFLR	<i>Pipe fixing brackets for PFLR</i>	18
Staffa fissaggio tubi per PTR/PFL	<i>Pipe fixing brackets for PTR/PFL</i>	18
Morsetto fissatubo	<i>Pipe fastening clamp</i>	19
Gaffetta	<i>Collar</i>	19
Cavallotto	<i>U bolt</i>	20
Piastrina per fissaggio piatto di terra	<i>Fixing plate for earth bar</i>	20
Bullone fissaggio sostegni	<i>Support fixing bolt</i>	20-21
Vite a testa esagonale	<i>Exagon head screw</i>	21
Rondella piana	<i>Washer</i>	21
Rondella elastica	<i>Serrated lock washer</i>	22
Dado	<i>Nut</i>	22
Barra filettata	<i>Threaded rod</i>	22
Tassello ad espansione	<i>Screw anchor</i>	23
Vernice per ritocchi a base di zinco	<i>Touch-up paint of zinc</i>	23
Piatto	<i>Plate</i>	23
Angolare	<i>Equal angular</i>	24
Ferro ad "U"	<i>U iron</i>	24
Tubo conduit	<i>Conduit</i>	24



INTRODUZIONE

La lunga esperienza nel settore dei montaggi industriali ha portato a studiare e realizzare tutta una serie di ancoraggi e staffaggi che consentono un facile e rapido utilizzo senza la necessità di attrezzature particolari.

SITIE da anni lavora in regime di qualità; a garanzia dei propri prodotti e servizi ha ottenuto le certificazioni ISO 9001, ISO 14001 e ISO 45001.

Il materiale generalmente usato per la costruzione dei profili è S275JR (UNI EN-10025) zincato a caldo per immersione dopo la lavorazione secondo norme ISO 1461.

I profilati doppi vengono realizzati con l'unione, a mezzo saldatura con procedimento MAG.

I profilati semplici possono essere realizzati pieni o con asole 11x30 mm sulla base.

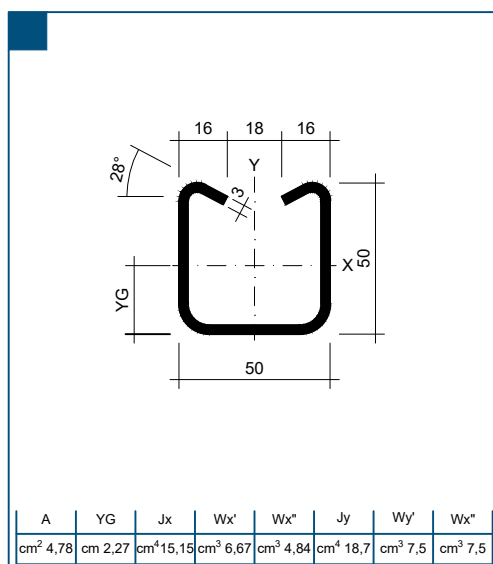
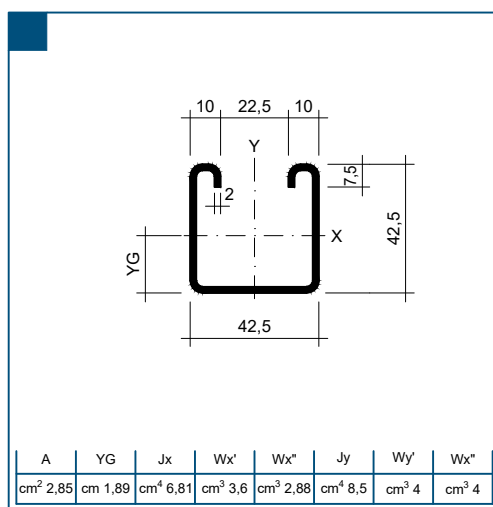
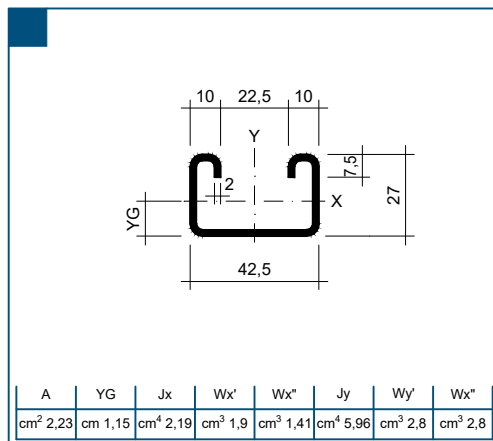

4 [note tecniche]

Member of CISQ Federation



CERTIFIED MANAGEMENT SYSTEM

ISO 9001 - ISO 14001
ISO 45001

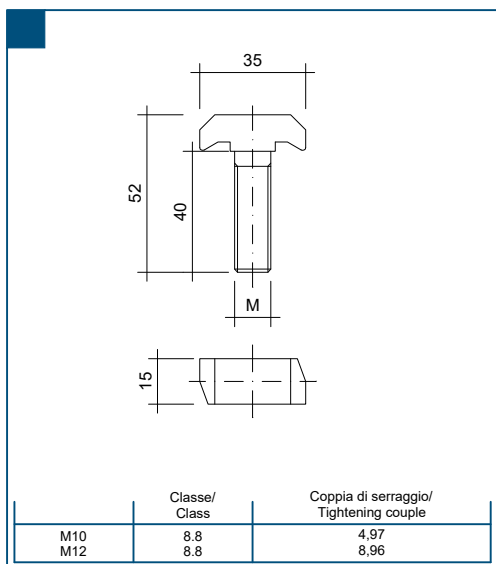

Bullone fissaggio sostegni.
Support fixing bolt.

INTRODUCTION

Our long experience in the field of industrial installations has permitted to design and carry out many types of anchor fixings and brackets which allow an easy and fast use without any kind of special tools.

SITIE has been working for several years under quality control systems, and obtained ISO 9001-2000, ISO 14001 and 45001 certifications for quality, environment and safety, which guarantee the reliability of our products and services.

They are made of carbon steel S275JR (UNI EN-10025) hot dip galvanized after working according to ISO 1461.

Double section profiles are obtained by MAG welding process of two single steel sections.

Single profiles can be manufactured solid type or with slots 11x30mm.

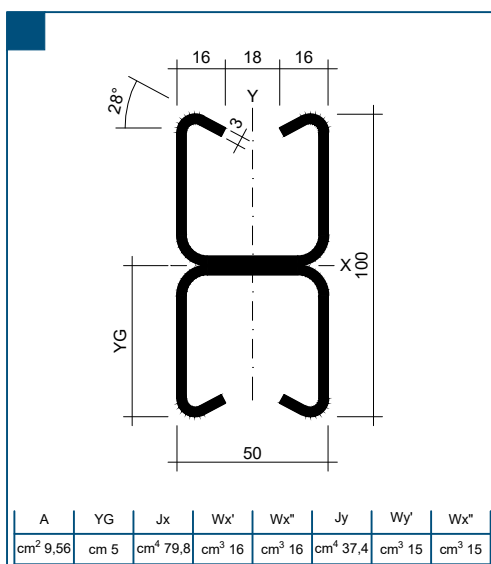
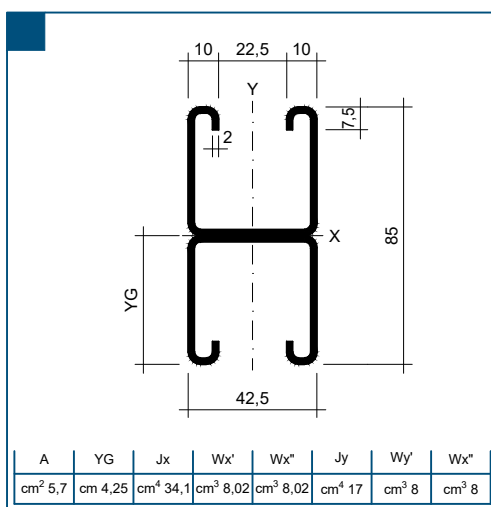
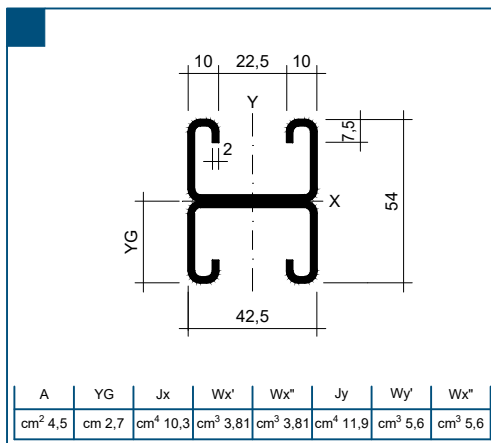



[sostegno verticale asolato | holed vertical support]

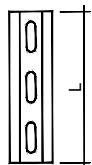

ELEMENTO | ELEMENT

CODICE | CODE

Descr.	L	Th
SV-F/42x27/3000	3000	2
SV-F/42x27/6000	6000	2

HDG	AISI 304	AISI 316
S0VF3027	*	*
S0VF6027	*	*

* A richiesta - On request

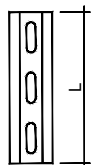

ELEMENTO | ELEMENT

CODICE | CODE

Descr.	L	Th
SV-F/42x42/3000	3000	2
SV-F/42x42/6000	6000	2

HDG	AISI 304	AISI 316
S0VF3042	*	*
S0VF6042	*	*

* A richiesta - On request

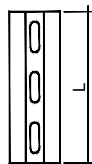
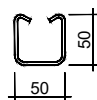

ELEMENTO | ELEMENT

CODICE | CODE

Descr.	L	Th
SV-F/50x50/3000	3000	3
SV-F/50x50/6000	6000	3

HDG	AISI 304	AISI 316
S0VF3050	*	*
S0VF6050	*	*

* A richiesta - On request

[sostegno verticale semplice | simple vertical support]

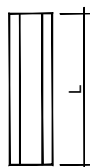

ELEMENTO | ELEMENT

CODICE | CODE

Descr.	L	Th
SV-S/42x27/3000	3000	2
SV-S/42x27/6000	6000	2

HDG	AISI 304	AISI 316
SOVS3027	*	*
SOVS6027	*	*

* A richiesta - On request

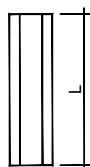

ELEMENTO | ELEMENT

CODICE | CODE

Descr.	L	Th
SV-S/42x42/3000	3000	2
SV-S/42x42/6000	6000	2

HDG	AISI 304	AISI 316
SOVS3042	*	*
SOVS6042	*	*

* A richiesta - On request

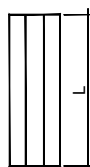

ELEMENTO | ELEMENT

CODICE | CODE

Descr.	L	Th
SV-S/50x50/3000	3000	3
SV-S/50x50/6000	6000	3

HDG	AISI 304	AISI 316
SOVS3050	*	*
SOVS6050	*	*

* A richiesta - On request



[sostegno verticale doppio | double vertical support]

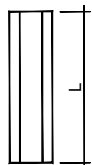
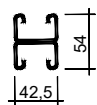

ELEMENTO | ELEMENT

CODICE | CODE

Descr.	L	Th
SV-D/42x27/3000	3000	2
SV-D/42x27/6000	6000	2

HDG	AISI 304	AISI 316
S0VD3027	*	*
S0VD6027	*	*

* A richiesta - On request

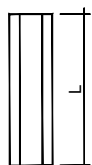
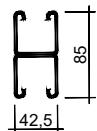

ELEMENTO | ELEMENT

CODICE | CODE

Descr.	L	Th
SV-D/42x42/3000	3000	2
SV-D/42x42/6000	6000	2

HDG	AISI 304	AISI 316
S0VD3042	*	*
S0VD6042	*	*

* A richiesta - On request

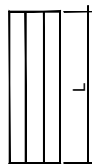
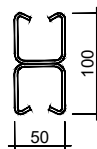

ELEMENTO | ELEMENT

CODICE | CODE

Descr.	L	Th
SV-D/50x50/3000	3000	3
SV-D/50x50/6000	6000	3

HDG	AISI 304	AISI 316
S0VD3050	*	*
S0VD6050	*	*

* A richiesta - On request

[sostegno orizzontale | horizontal support]

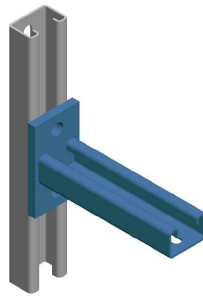
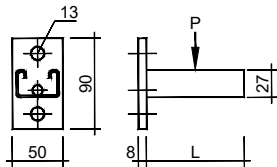

ELEMENTO | ELEMENT

Descr.	L	P	Th
SOF-50/27	97	3000	2
SOF-100/27	147	3000	2
SOF-200/27	247	2000	2
SOF-300/27	347	1400	2
SOF-400/27	447	1000	2

CODICE | CODE

HDG	AISI 304	AISI 316
SOSO2701	*	*
SOSO2702	*	*
SOSO2704	*	*
SOSO2706	*	*
SOSO2708	*	*

⁽¹⁾ Coefficiente di sicurezza 2,5 - Safety coefficient of 2,5. * A richiesta - On request

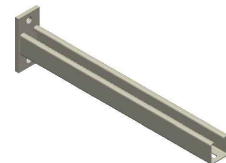
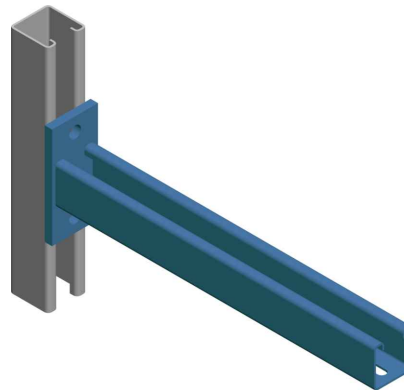
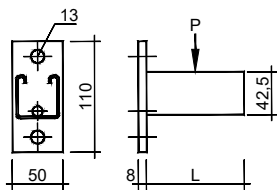

ELEMENTO | ELEMENT

Descr.	L	P	Th
SOF-300/42	347	2900	2
SOF-400/42	447	2200	2
SOF-500/42	547	1800	2

CODICE | CODE

HDG	AISI 304	AISI 316
SOSO4206	*	*
SOSO4208	*	*
SOSO4210	*	*

⁽¹⁾ Coefficiente di sicurezza 2,5 - Safety coefficient of 2,5. * A richiesta - On request

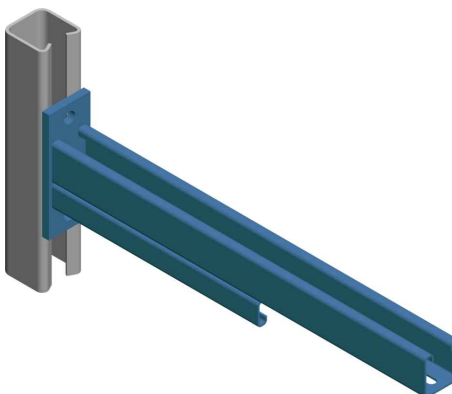
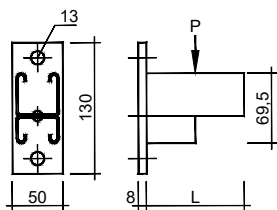

ELEMENTO | ELEMENT

Descr.	L	P	Th
SOF-400/69	447	5000	2
SOF-500/69	547	4000	2
SOF-600/69	647	3400	2

CODICE | CODE

HDG	AISI 304	AISI 316
SOSO6908	*	*
SOSO6910	*	*
SOSO6912	*	*

⁽¹⁾ Coefficiente di sicurezza 2,5 - Safety coefficient of 2,5. * A richiesta - On request



[sostegno orizzontale | horizontal support]

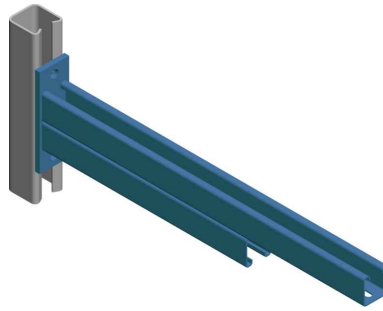
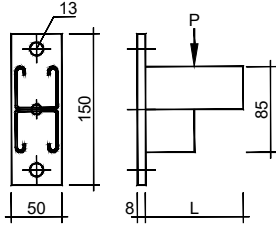

ELEMENTO | ELEMENT

CODICE | CODE

Descr.	L	P	Th
SOF-500/84	547	5200	2
SOF-600/84	647	4300	2

HDG	AISI 304	AISI 316
SOSO8410	*	*
SOSO8412	*	*

⁽¹⁾ Coefficiente di sicurezza 2,5 - Safety coefficient of 2,5. * A richiesta - On request

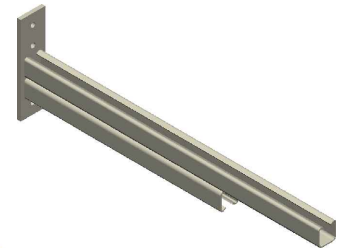
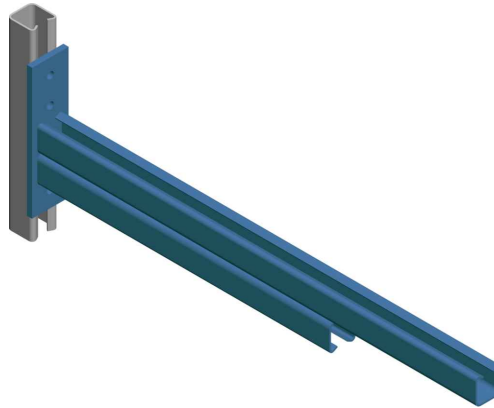
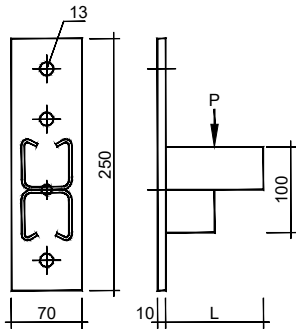

ELEMENTO | ELEMENT

CODICE | CODE

Descr.	L	P	Th
SOF-800/100	840	6000	3

HDG	AISI 304	AISI 316
SOSO1016	*	*

⁽¹⁾ Coefficiente di sicurezza 2,5 - Safety coefficient of 2,5. * A richiesta - On request

[fissaggio sostegno verticale | vertical support fastener]

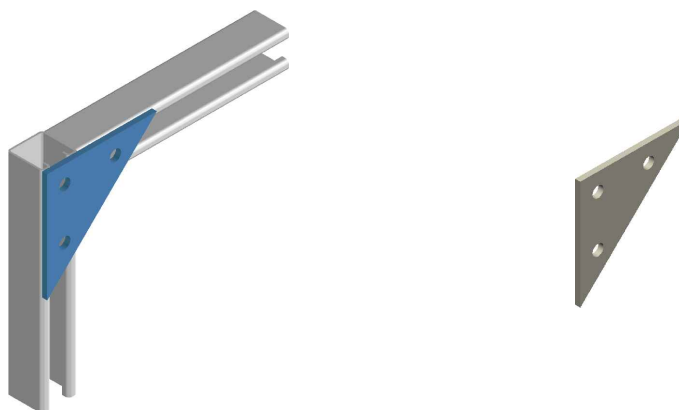
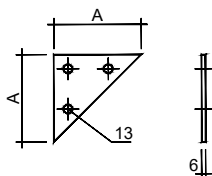

ELEMENTO | ELEMENT

CODICE | CODE

Descr.	A	HDG	AISI 304	AISI 316
FSV-CT/42	130	S0FS00CT	*	*
FSV-CT/50	150	S0FS50CT	*	*

* A richiesta - On request

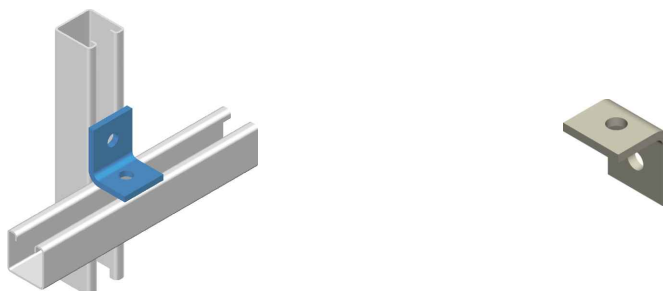
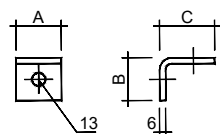

ELEMENTO | ELEMENT

CODICE | CODE

Descr.	A	B	C	HDG	AISI 304	AISI 316
FSV-SL/42	45	42,5	54,5	S0FS00SL	*	*
FSV-SL/50	50	50	62	S0FS50SL	*	*

* A richiesta - On request

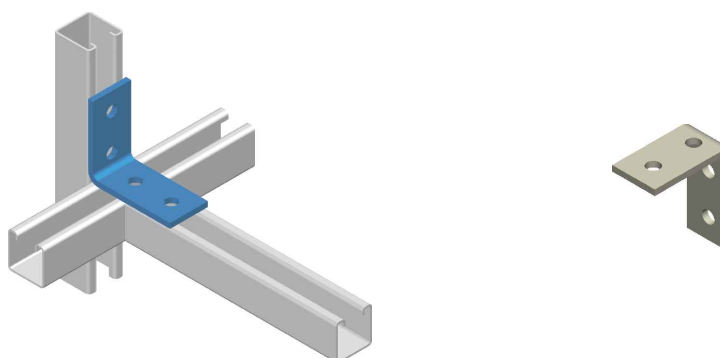
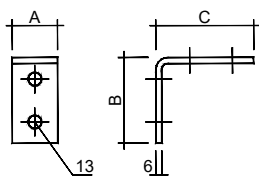

ELEMENTO | ELEMENT

CODICE | CODE

Descr.	A	B	C	HDG	AISI 304	AISI 316
FSV-DL/42	45	85	97	S0FS00DL	*	*
FSV-DL/50	50	100	112	S0FS50DL	*	*

* A richiesta - On request



[fissaggio sostegno verticale | vertical support fastener]

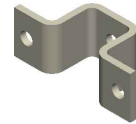
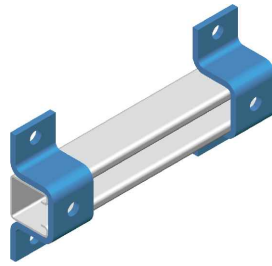
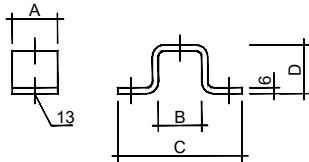

ELEMENTO | ELEMENT

CODICE | CODE

Descr.	A	B	C	D
FSV-SU/27	45	43	123	33
FSV-SU/42	45	43	123	48,5
FSV-SU/50	50	51	163	56

HDG	AISI 304	AISI 316
S0FS27SU	*	*
S0FS42SU	*	*
S0FS50SU	*	*

* A richiesta - On request

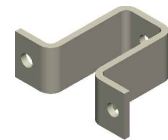
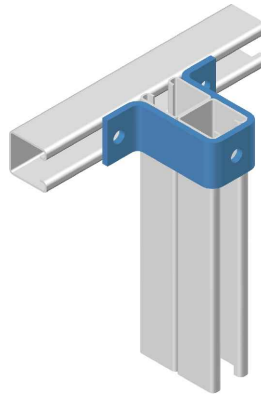
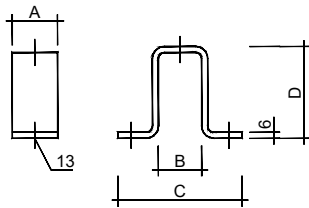

ELEMENTO | ELEMENT

CODICE | CODE

Descr.	A	B	C	D
FSV-DU/27	45	43	123	60
FSV-DU/42	45	43	123	91
FSV-DU/50	50	51	163	106

HDG	AISI 304	AISI 316
S0FS27DU	*	*
S0FS42DU	*	*
S0FS50DU	*	*

* A richiesta - On request

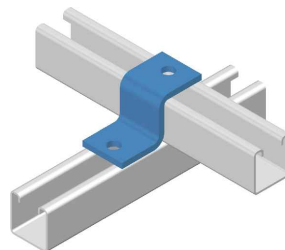
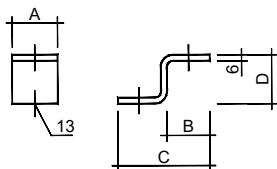

ELEMENTO | ELEMENT

CODICE | CODE

Descr.	A	B	C	D
FSV-SZ/27	45	42,5	91	33
FSV-SZ/42	45	42,5	91	48,5
FSV-SZ/50	50	50	106	56

HDG	AISI 304	AISI 316
S0FS27SZ	*	*
S0FS42SZ	*	*
S0FS50SZ	*	*

* A richiesta - On request

[fissaggio sostegno verticale | vertical support fastener]

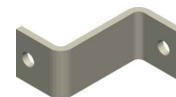
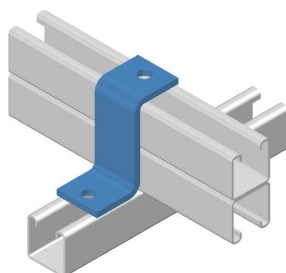
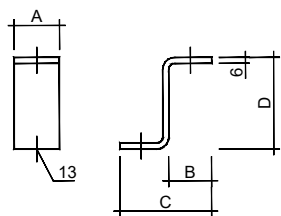

ELEMENTO | ELEMENT

CODICE | CODE

Descr.	A	B	C	D
FSV-DZ/27	45	42,5	91	60
FSV-DZ/42	45	42,5	91	91
FSV-DZ/50	50	50	106	106

HDG	AISI 304	AISI 316
S0FS27DZ	*	*
S0FS42DZ	*	*
S0FS50DZ	*	*

* A richiesta - On request

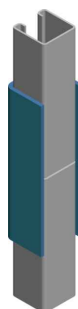
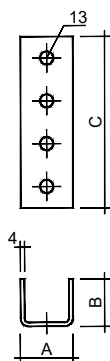

ELEMENTO | ELEMENT

CODICE | CODE

Descr.	A	B	C
FSV-SR/27	52	31	170
FSV-SR/42	52	47	170
FSV-SR/50	60	54	200

HDG	AISI 304	AISI 316
S0FS27SR	*	*
S0FS42SR	*	*
S0FS50SR	*	*

* A richiesta - On request

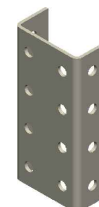
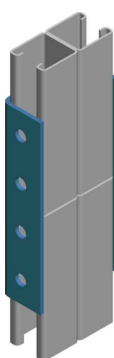
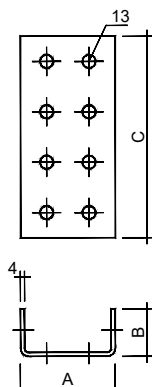

ELEMENTO | ELEMENT

CODICE | CODE

Descr.	A	B	C
FSV-DR/27	63	47	170
FSV-DR/42	94	47	170
FSV-DR/50	110	54	200

HDG	AISI 304	AISI 316
S0FS27DR	*	*
S0FS42DR	*	*
S0FS50DR	*	*

* A richiesta - On request



[fissaggio sostegno verticale | vertical support fastener]

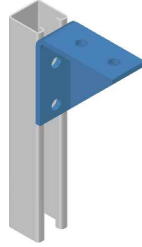
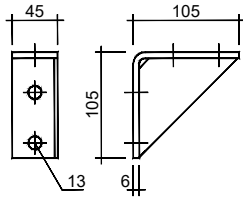

ELEMENTO | ELEMENT

CODICE | CODE

Descr.	Th	HDG	AISI 304	AISI 316
FSV-D1	3	S0FS00D1	*	*

* A richiesta - On request

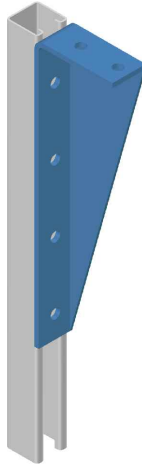
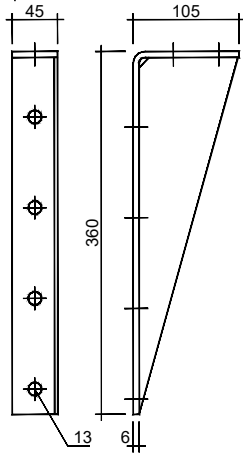

ELEMENTO | ELEMENT

CODICE | CODE

Descr.	Th	HDG	AISI 304	AISI 316
FSV-D2	3	S0FS00D2	*	*

* A richiesta - On request

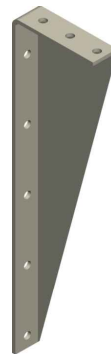
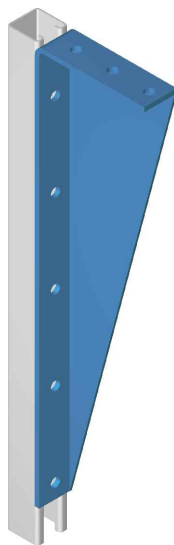
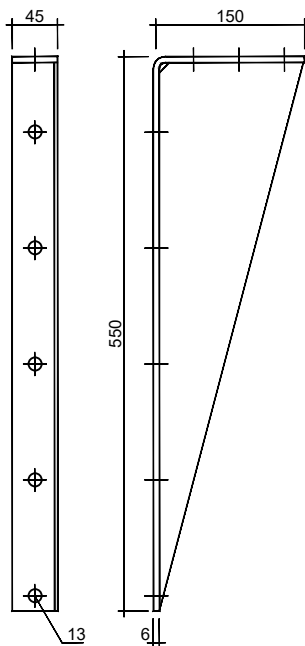

ELEMENTO | ELEMENT

CODICE | CODE

Descr.	Th	HDG	AISI 304	AISI 316
FSV-D3	3	S0FS00D3	*	*

* A richiesta - On request

[fissaggio sostegno verticale | vertical support fastener]

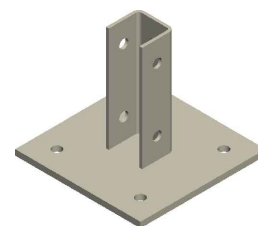
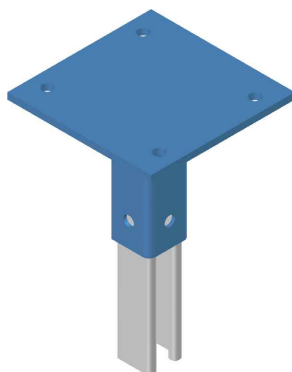
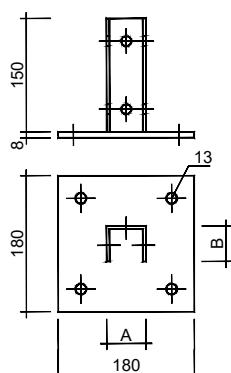

ELEMENTO | ELEMENT

CODICE | CODE

Descr.	A	B	Th
FSV-SP/27	52	31	4
FSV-SP/42	52	47	4
FSV-SP/50	60	54	4

HDG	AISI 304	AISI 316
S0FS27SP	*	*
S0FS42SP	*	*
S0FS50SP	*	*

* A richiesta - On request

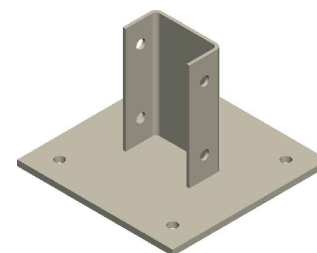
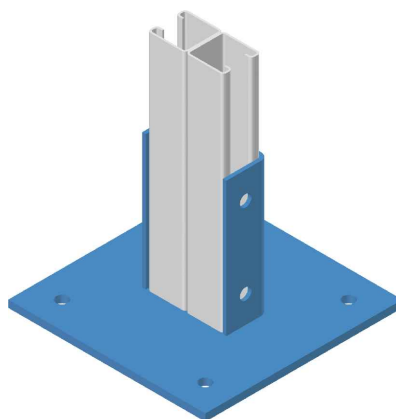
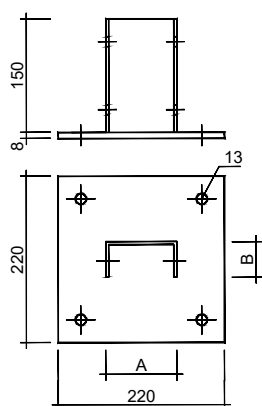

ELEMENTO | ELEMENT

CODICE | CODE

Descr.	A	B	Th
FSV-DP/27	63	31	4
FSV-DP/42	94	47	4
FSV-DP/50	107	54	4

HDG	AISI 304	AISI 316
S0FS27DP	*	*
S0FS42DP	*	*
S0FS50DP	*	*

* A richiesta - On request



[fissaggio sostegno verticale | vertical support fastener]

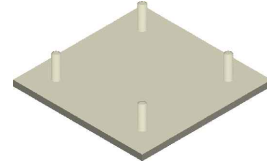
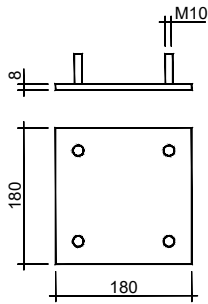

ELEMENTO | ELEMENT

CODICE | CODE

Descr.
FSV-SC

GRE
S0FS00SC

AISI 304
*

AISI 316
*

* A richiesta - On request

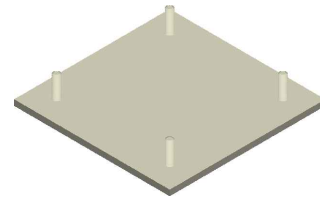
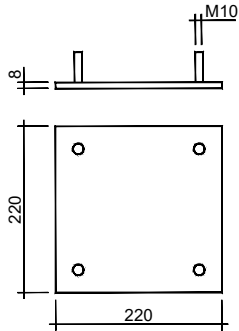

ELEMENTO | ELEMENT

CODICE | CODE

Descr.
FSV-DC

GRE
S0FC00DC

AISI 304
*

AISI 316
*

* A richiesta - On request

[fissaggio a trave | rack fastening clamp]

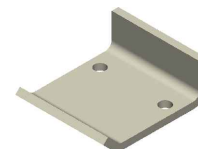
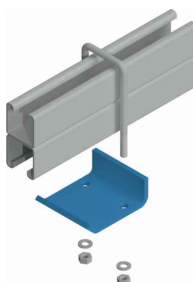
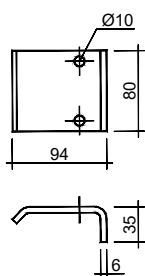

ELEMENTO | ELEMENT

CODICE | CODE

Descr.	HDG	AISI 304	AISI 316
FT-42/50	AZFT0000ARW	AIFT0000ARW	AYFT0000ARW

[cavallotto per fissaggio a trave | U bolt for rack fastening clamp]

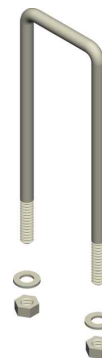
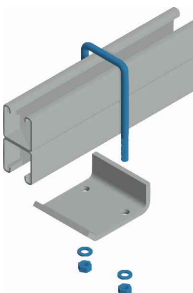
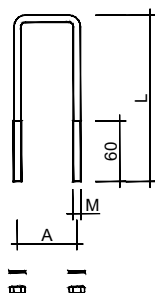

ELEMENTO | ELEMENT

CODICE | CODE

Descr.	M	A	L	EGS	AISI 304	AISI 316
M8x120	8	59	120	VE0843	VI0843	VY0843
M8x165	8	59	165	VE0873	VI0873	VY0873

[piastra per fissaggio a trave | plate for rack fastening clamp]

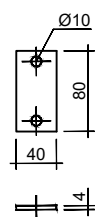

ELEMENTO | ELEMENT

CODICE | CODE

Descr.	EGS	AISI 304	AISI 316
PS-80x40x4	AZPS0000BER	AIPS0000BER	AYPS0000BER



[staffa fissaggio tubi per PTR | pipe fixing brackets for PTR]

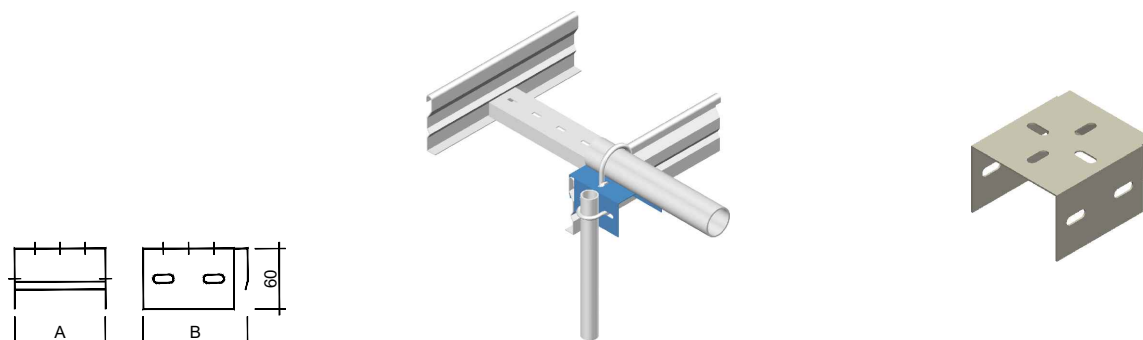

ELEMENTO | ELEMENT

CODICE | CODE

Descr.	A	B	Th	HDG	AISI 304	AISI 316
SSFT-1 (3/4"- 1.1/2")	90	105	1,5	S0FT0001	*	*
SSFT-2 (2"- 4")	170	185	1,5	S0FT0002	*	*

* A richiesta - On request

[staffa fissaggio tubi per PFLR | pipe fixing brackets for PFLR]

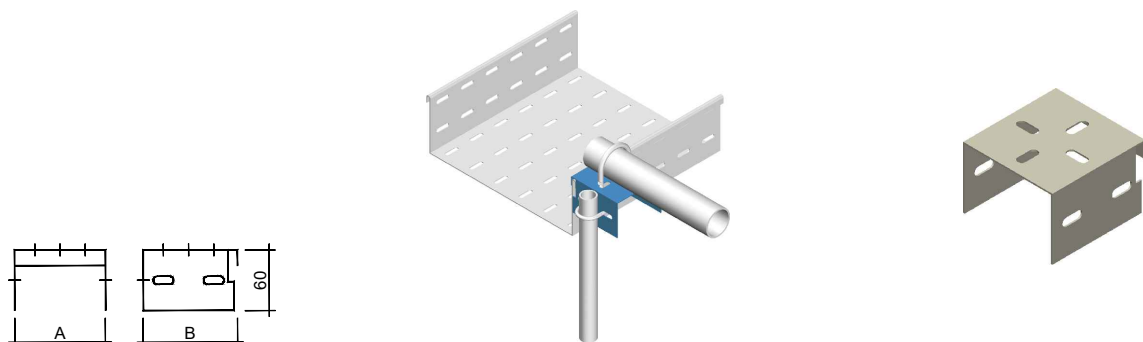

ELEMENTO | ELEMENT

CODICE | CODE

Descr.	A	B	Th	HDG	AISI 304	AISI 316
SSFT-3 (3/4"- 1.1/2")	90	95	1,5	S0FT0003	*	*
SSFT-4 (2"- 4")	170	175	1,5	S0FT0004	*	*

* A richiesta - On request

[staffa fissaggio tubi per PTR/PFL | pipe fixing brackets for PTR/PFL]

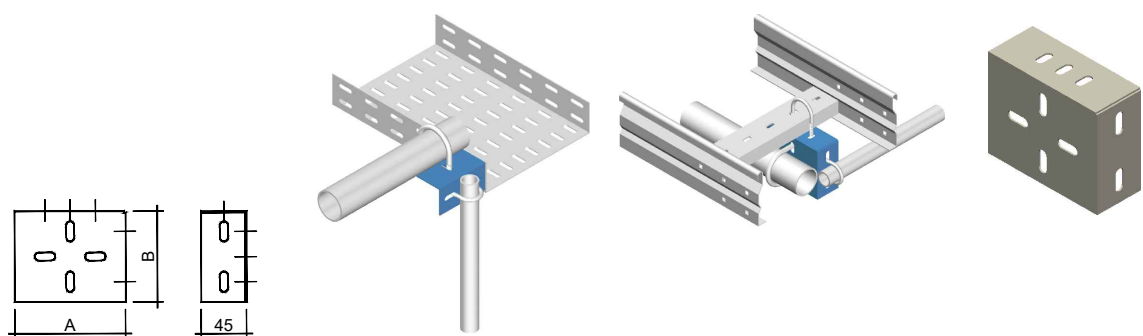

ELEMENTO | ELEMENT

CODICE | CODE

Descr.	A	B	Th	HDG	AISI 304	AISI 316
SIFT-1 (3/4"- 1.1/2")	110	90	1,5	S0FT0011	*	*
SIFT-2 (2"- 4")	170	170	1,5	S0FT0012	*	*

* A richiesta - On request

[morsetto fissatubo | pipe fastening clamp]

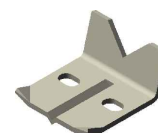
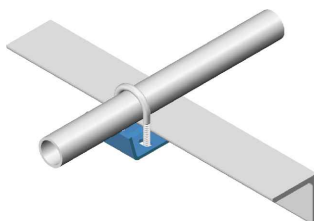
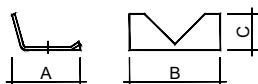

ELEMENTO | ELEMENT

CODICE | CODE

Ø Tubo / Ø Conduit	A	B	C	EGS	AISI 304	AISI 316
1/2" - 3/4"	55	50	29	TE070011	*	*
1" - 1.1/4"	62	70	34	TE070013	*	*
1.1/2" - 2"	68	90	39	TE070015	*	*

* A richiesta - On request

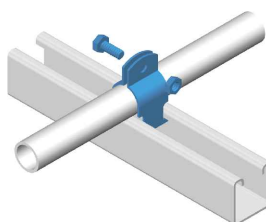
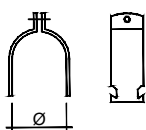

ELEMENTO | ELEMENT

CODICE | CODE

Ø Tubo / Ø Conduit	EGS	AISI 304	AISI 316
1/2"	MV0200000ET04	*	*
3/4"	MV0200000ET05	*	*
1"	MV0200000ET06	*	*
1.1/4"	MV0200000ET07	*	*
1.1/2"	MV0200000ET08	*	*
2"	MV0200000ET09	*	*

* A richiesta - On request

[gaffetta | collar]

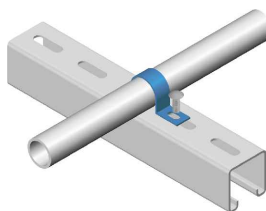
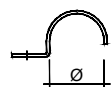

ELEMENTO | ELEMENT

CODICE | CODE

Ø Tubo / Ø Conduit	EGS	AISI 304	AISI 316
1/2"	MV0200000GF04	*	*
3/4"	MV0200000GF05	*	*
1"	MV0200000GF06	*	*
1.1/4"	MV0200000GF07	*	*
1.1/2"	MV0200000GF08	*	*
2"	MV0200000GF09	*	*

* A richiesta - On request

[cavallotto | U bolt]

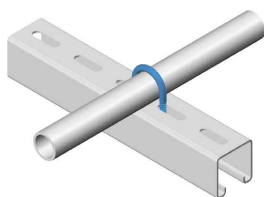
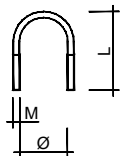

ELEMENTO | ELEMENT

Ø Tubo / Ø Conduit	M	L
1/2"	6	58
3/4"	6	62
1"	6	70
1.1/4"	6	78
1.1/2"	8	90
2"	8	102

CODICE | CODE

EGS	AISI 304	AISI 316
MV0200000CL04	*	*
MV0200000CL05	*	*
MV0200000CL06	*	*
MV0200000CL07	*	*
MV0200000CL08	*	*
MV0200000CL09	*	*

* A richiesta - On request

[piastrina per fissaggio piatto di terra | fixing plate for earth bar]

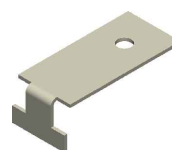
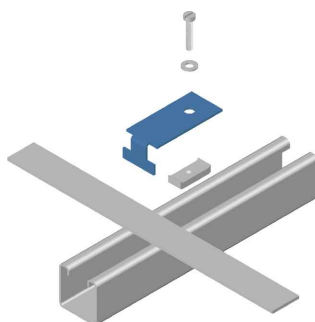
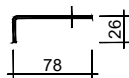

ELEMENTO | ELEMENT

Descr.	Th
FR-405	2

CODICE | CODE

RAME	AISI 304	AISI 316
S0FR0000	*	*

* A richiesta - On request

[bullone fissaggio sostegni | support fixing bolt]

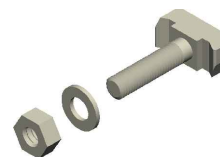
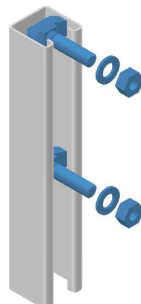
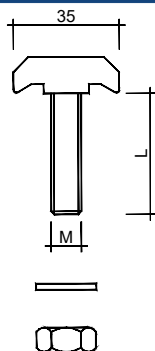

ELEMENTO | ELEMENT

Descr.	M	L
Vite ad ancora / Anchor bolt	10	40
Rondella piana / Washer		
Dado / Nut		
Vite ad ancora / Anchor bolt	12	40
Rondella piana / Washer		
Dado / Nut		

CODICE | CODE

HDG	AISI 304	AISI 316
VZ1040	*	*
VZRP10	*	*
VZDM10	*	*
VZ1240	*	*
VZRP12	*	*
VZDM12	*	*

* A richiesta - On request

[bullone fissaggio sostegni | support fixing bolt]

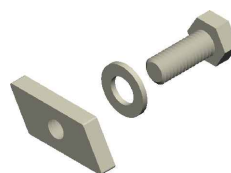
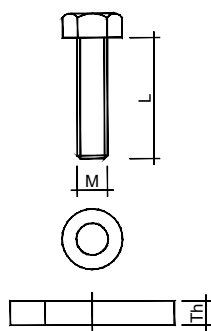

ELEMENTO | ELEMENT

CODICE | CODE

Descr.	M	L
Vite / Screw	12	30
Rondella piana / Washer		
Dado ad ancora / Anchor nut		

HDG	AISI 304	AISI 316
MC06TE0012030	*	*
VZRP12	*	*
VZA012	*	*

* A richiesta - On request

[vite a testa esagonale | hexagon head screw]

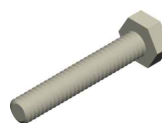
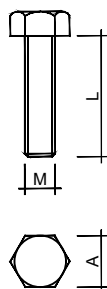

ELEMENTO | ELEMENT

CODICE | CODE

Descr.	M	L	A
UNI 5739	6	20	10
UNI 5739	6	40	10
UNI 5739	6	60	10
UNI 5739	8	20	13
UNI 5739	8	40	13
UNI 5739	8	60	13
UNI 5739	10	40	17
UNI 5739	10	60	17
UNI 5739	10	80	17
UNI 5737	10	100	17
UNI 5739	12	40	19
UNI 5739	12	60	19
UNI 5739	12	80	19
UNI 5737	12	100	19

EGS	AISI 304	AISI 316
MC01TE0006020	*	*
MC01TE0006040	*	*
MC01TE0006060	*	*
MC01TE0008020	*	*
MC01TE0008040	*	*
MC01TE0008060	*	*
MC01TE0010020	*	*
MC01TE0010040	*	*
MC01TE0010060	*	*
MC01TE0010100	*	*
MC01TE0012040	*	*
MC01TE0012060	*	*
MC01TE0012080	*	*
MC01TE0012100	*	*

Nota / Note: altre misure a richiesta - other dimensions on request. * A richiesta - On request

[rondella piana | washer]

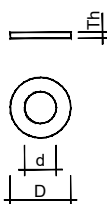

ELEMENTO | ELEMENT

CODICE | CODE

Descr.	D	d	Th
UNI 6592	12	6,4	1,6
UNI 6592	16	8,4	1,6
UNI 6592	20	10,5	2
UNI 6592	24	13	2,5

EGS	AISI 304	AISI 316
MC01RP0006000	*	*
MC01RP0008000	*	*
MC01RP0010000	*	*
MC01RP0012000	*	*

Nota / Note: altre misure a richiesta - other dimensions on request. * A richiesta - On request

[rondella elastica | serrated lock washer]



ELEMENTO | ELEMENT

CODICE | CODE

Descr.	D	d	Th	EGS	AISI 304	AISI 316
UNI 1751-A	11,8	6,1	1,6	MC01RG0006000	*	*
UNI 1751-A	14,8	8,1	2,2	MC01RG0008000	*	*
UNI 1751-A	18,1	10,2	2,2	MC01RG0010000	*	*
UNI 1751-A	21,1	12,2	2,5	MC01RG0012000	*	*

Nota / Note: altre misure a richiesta - other dimensions on request. * A richiesta - On request

[dado | nut]

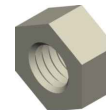
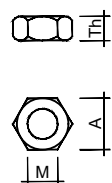

ELEMENTO | ELEMENT

CODICE | CODE

Descr.	M	Th	A	EGS	AISI 304	AISI 316
UNI 5588	6	5	10	MC01DM0006000	*	*
UNI 5588	8	6,5	13	MC01DM0008000	*	*
UNI 5588	10	8	17	MC01DM0010000	*	*
UNI 5588	12	10	19	MC01DM0012000	*	*

Nota / Note: altre misure a richiesta - other dimensions on request. * A richiesta - On request

[barra filettata | threaded rod]

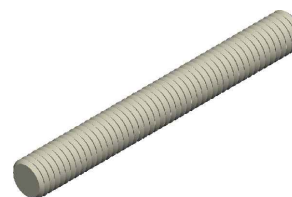
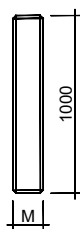

ELEMENTO | ELEMENT

CODICE | CODE

Descr.	M	EGS	AISI 304	AISI 316
DIN 976	6	MC01BF0006000	MC03BF0006000	*
DIN 976	8	MC01BF0008000	MC03BF0008000	*
DIN 976	10	MC01BF0010000	MC03BF0010000	*
DIN 976	12	MC01BF0012000	MC03BF0012000	*

Nota / Note: altre misure a richiesta - other dimensions on request. * A richiesta - On request

[tassello ad espansione | screw anchor]

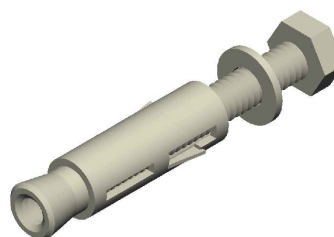
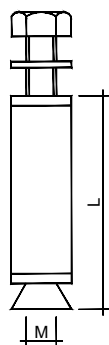

ELEMENTO | ELEMENT

CODICE | CODE

Descr.	M	L
	6	40
	8	55
	10	65
	12	80

EGS
MV0200000SLM6
MV0200000SLM8
MV0200000SLM10
MV0200000SLM12

Nota / Note: altre misure a richiesta - other dimensions on request.

[vernice per ritocchi a base di zinco | touch-up paint of zinc]

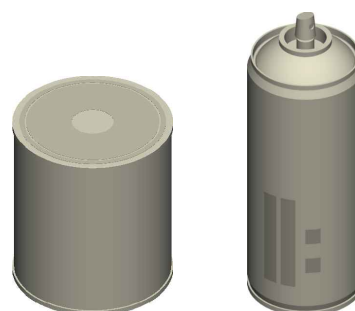

ELEMENTO | ELEMENT

CODICE | CODE

Descr.	Kg
Liquido / Liquid	1
Spruzzo / Spray	0,4

MD060ZINCANTE
MD06SPRZI0400

[piatto | plate]

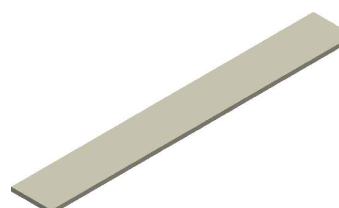
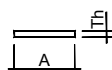

ELEMENTO | ELEMENT

CODICE | CODE

Descr.	A	Th
UNI 6014 30x3	30	3
UNI 6014 40x4	40	4
UNI 6014 50x5	50	5
UNI 6014 60x6	60	6

HDG
FPZM00P303
FPZM00P404
FPZM00P505
FPZM00P606

Nota / Note: altre misure a richiesta - other dimensions on request.

[angolare | equal angular]

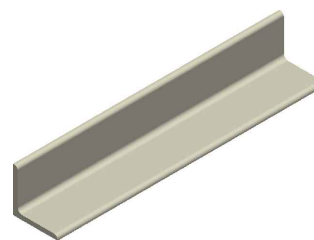
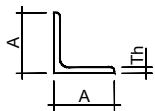

ELEMENTO | ELEMENT

CODICE | CODE

Descr.	A	Th
UNI 5783 30x3	30	3
UNI 5783 40x4	40	4
UNI 5783 50x5	50	5
UNI 5783 60x6	60	6

HDG
FPZM00A303
FPZM00A404
FPZM00A505
FPZM00A606

Nota / Note: altre misure a richiesta - other dimensions on request.

[ferro ad "U" | U iron]

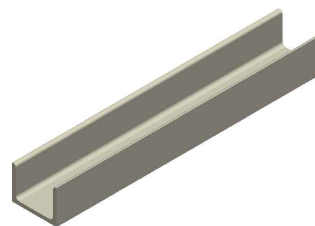
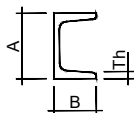

ELEMENTO | ELEMENT

CODICE | CODE

Descr.	A	B	Th
UNI 5786 30x15x5	30	15	5
UNI 5680 50x38x5	50	38	5
UNI 5680 65x42x5,5	65	42	5,5
UNI 5680 80x45x6	80	45	6
UNI 5680 100x45x6	100	50	6

HDG
FPZM000U30
FPZM000U50
FPZM000U65
FPZM000U80
FPZM000U100

Nota / Note: altre misure a richiesta - other dimensions on request.

[tubo conduit | conduit]

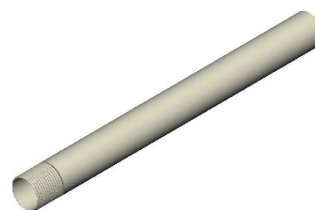

ELEMENTO | ELEMENT

CODICE | CODE

Descr.	Ø
AD-PE UNI 7683 1/2"	1/2"
AD-PE UNI 7683 3/4"	3/4"
AD-PE UNI 7683 1"	1"
AD-PE UNI 7683 1.1/2"	1.1/2"
AD-PE UNI 7683 2"	2"
AD-PE UNI 7683 2.1/2"	2.1/2"
AD-PE UNI 7683 3"	3"

HDG
FTCZM00021
FTCZM00027
FTCZM00033
FTCZM00048
FTCZM00060
FTCZM00076
FTCZM00089

Nota / Note: altre misure a richiesta - other dimensions on request.

SITIE

IMPIANTI INDUSTRIALI SpA



Sitie Impianti Industriali S.p.A.
Società con Unico Socio Soggetta all'attività di direzione e coordinamento di Aurora 2010 Srl
Sede Legale: V.le Tiziano, 80 -00196 ROMA
Uff. Amm.vi e Stabilimento: Via Finati, 6 - 44124 FERRARA (FE) - Italy
Tel. +39 0532 734611 - Fax +39 0532 734603
Cap. Soc. € 4.000.000 i.v. - Reg. Impr. RM 01038020382 - R.E.A. n. RM- 1578148 C.F. e P.I. IT 01038020382
<http://www.sitie.it>

